

5/28/2026 2:42:15 PM

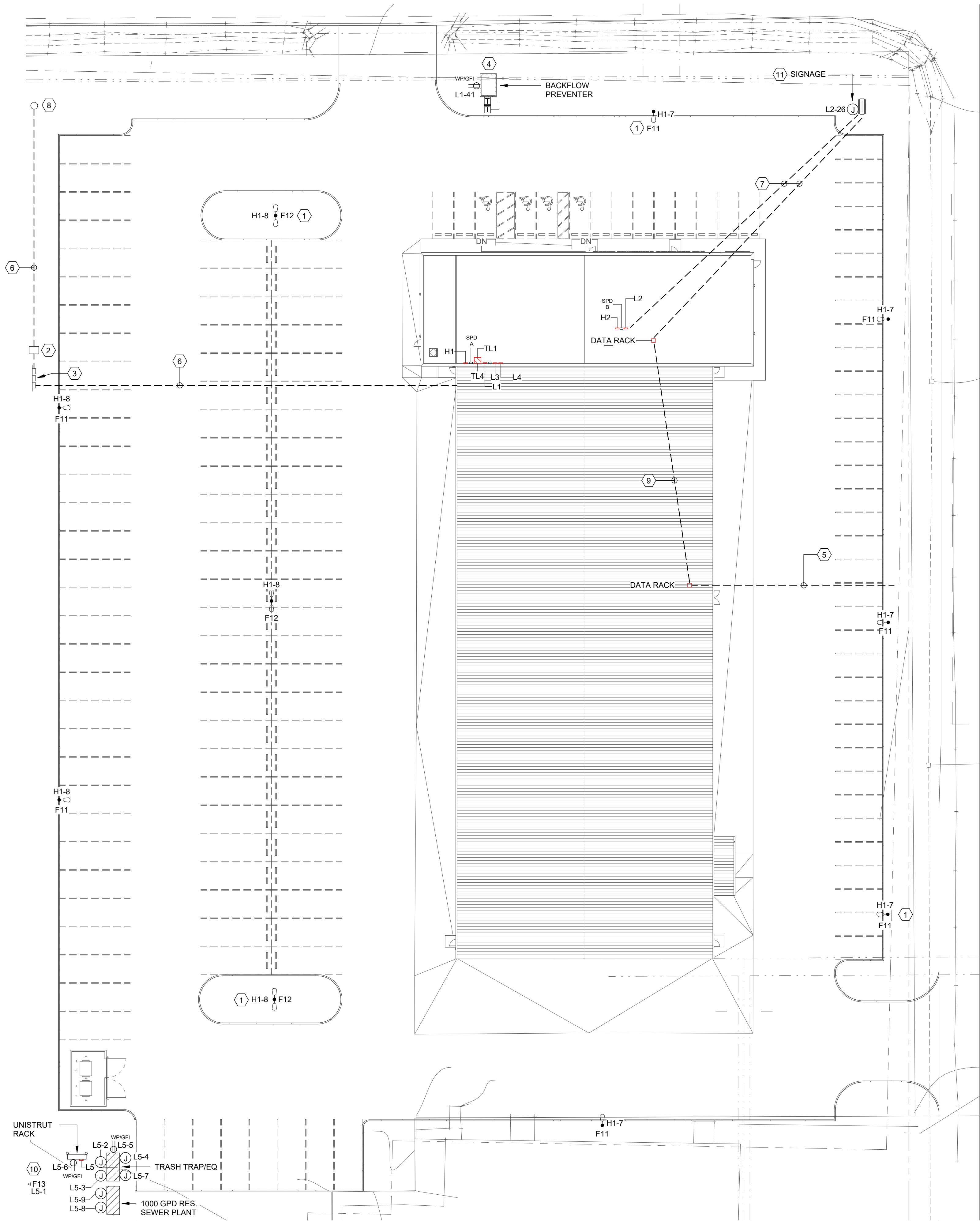

1 ENLARGED ELECTRICAL SITE PLAN  
1:300

### ELECTRICAL SITE PLAN KEYNOTES:

- 1 PROVIDE WITH CONCRETE FOUNDATION/ BASE. SEE DETAILS, TYPICAL ALL POLE LIGHTS. CONTROL POLE LIGHTS WITH PHOTOCELL / TIMECLOCK COMBINATION VIA NLIGHT RELAY PANEL.
- 2 APPROXIMATE LOCATION OF NEW UTILITY TRANSFORMER. COORDINATE REQUIREMENTS WITH UTILITY COMPANY. REFER TO ELECTRICAL RISER DIAGRAM.
- 3 APPROXIMATE LOCATION OF NEW ELECTRICAL SERVICE ENTRANCE. REFER TO ELECTRICAL RISER DIAGRAM.
- 4 APPROXIMATE LOCATION OF BACKFLOW PREVENTOR HOT BOX. COORDINATE FINAL LOCATION AND ALL TERMINATION REQUIREMENTS WITH PROVIDING CONTRACTOR PRIOR TO ROUGH-IN. INSTALL THE GFI/WP OUTLET IN HOT BOX ON INDEPENDENT MEANS OF SUPPORT. MAKE ALL CONNECTIONS TO BACKFLOW PREVENTOR VALVES WITH FIRE ALARM SYSTEM.
- 5 2-4" C UNDERGROUND AND STUBBED UP INTO DATA ROOM FOR COMMUNICATIONS ENTRANCE. PROVIDE PULLROPE. STUB UP IN GREEN SPACE NEAR STREET.
- 6 3-3" C FOR ELECTRICAL SERVICE ENTRANCE. COORDINATE ALL REQUIREMENTS WITH LOCAL UTILITY. REFER TO ELECTRICAL RISER DIAGRAM.
- 7 TWO 1" CONDUITS WITH PULLSTRING FOR POWER AND DATA TO SIGNAGE. COORDINATE EXACT LOCATION WITH ARCHITECT / OWNER. ROUTE THROUGH FIRST FLOOR WALLS TO GET TO 2ND FLOOR FOR DATA.
- 8 APPROXIMATE LOCATION OF NEW UTILITY POLE.
- 9 2-2" C W/ PULLSTRING OVERHEAD TO DROP DOWN AT EACH RESPECTIVE COMMUNICATIONS BACKBOARD.
- 10 FLOODLIGHT MOUNTED ON POLE. POLE SHALL BE RSS-10-T20-FB-1. COORDINATE EXACT LOCATION WITH ARCHITECT PRIOR TO ROUGH-IN.
- 11 CONTROL WITH PHOTOCELL / TIMECLOCK. VERIFY EXACT CONTROLS AND TERMINATION REQUIREMENTS WITH SIGNAGE SUPPLIER.

### ELECTRICAL SITE GENERAL NOTES:

- COORDINATE ALL SERVICE ENTRANCE REQUIREMENTS WITH LOCAL UTILITY PRIOR TO WORK.
- CONTRACTOR TO REMOVE ANY REMAINING ELECTRICAL ITEMS RELATED TO DEMOLISHED RV PEDESTALS, UNDERGROUND CONDUIT, ETC. TO PREPARE SITE FOR NEW WORK.

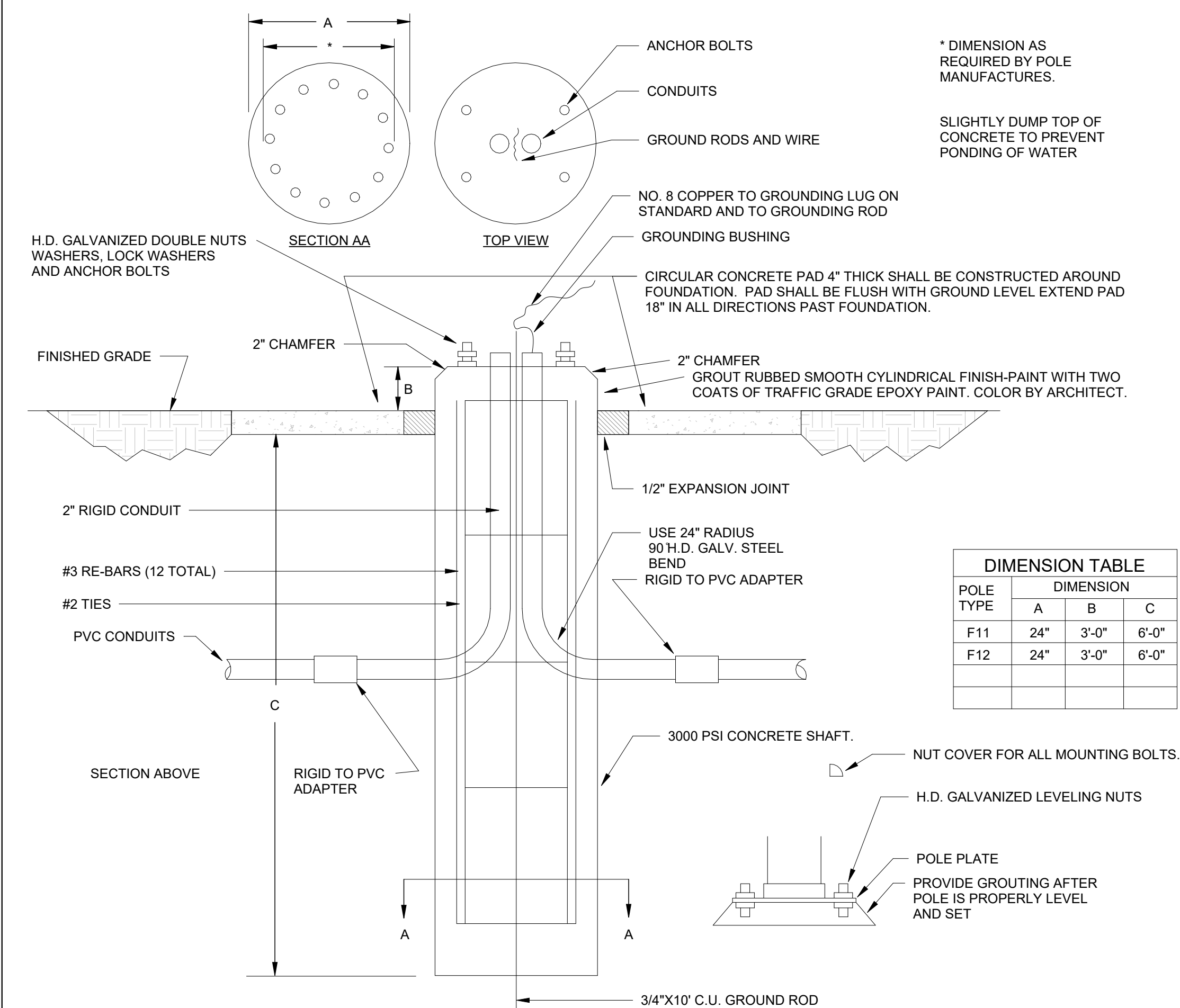

PROVIDE AND INSTALL FACTORY BOLT COVER FOR ALL POLES

3 TYP. LIGHT STANDARD FOUNDATION DETAIL  
N.T.S.

NOTE:  
SUBMIT DIGITAL PHOTOS TO ENGINEER OF INSTALLATION PRIOR TO POURING CONCRETE.



ASSOCIATED DESIGN GROUP, INC.  
3909 West Congress Street, Suite 201  
Lafayette, Louisiana 70506  
Phone: (337) 234-5710  
Email: adginc@adginc.org

Project No. 25326



NEW CONSTRUCTION  
FOR  
FORD PRO  
MIKE WILLIS  
2010 PATTON ST.

© COPYRIGHT 2019,  
RANDY M. GOODLOE, AIA, APAC  
ALL INFORMATION, EITHER DRAWN, WRITTEN,  
OR IMPLIED APPEARING IN THIS DOCUMENT  
SHALL NOT BE DUPLICATED, DISCLOSED, OR  
OTHERWISE USED WITHOUT THE WRITTEN  
PERMISSION OF THE AUTHOR, RANDY M.  
GOODLOE, AIA, APAC. THIS DOCUMENT IS AN  
INSTRUMENT OF SERVICE AND IS THE SOLE  
PROPERTY OF THE AUTHOR. FURTHERMORE,  
THE USE OF THIS DOCUMENT FOR ANY  
PURPOSE SHALL BE REVOKED, IF THE INTENT  
OF THE DESIGN OR THE CONSTRUCTION  
TECHNIQUES OR DETAILS SHOWN HEREIN  
ARE NOT ADHERED TO OR THE  
CONTRACTUAL AGREEMENT GOVERNING  
THEIR USE ARE NOT STRICTLY ADHERED TO.

PROJECT NO.  
25012

PROJECT MANAGER  
TM

DATE ISSUED  
2026.05.22

REVISED

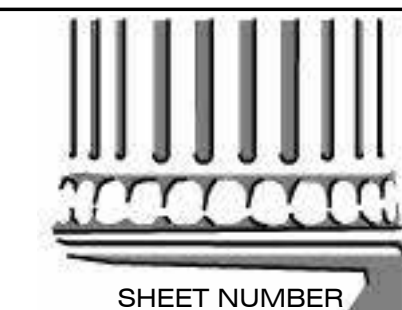

E-010  
SITE PLAN